

Bottom view

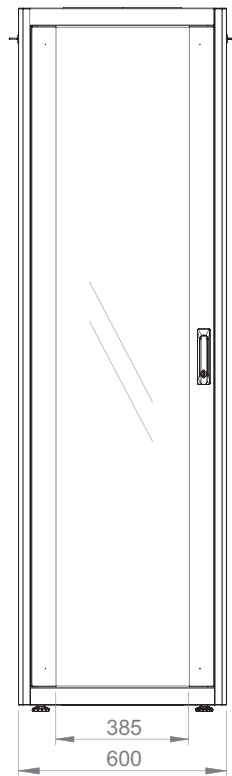

Front view

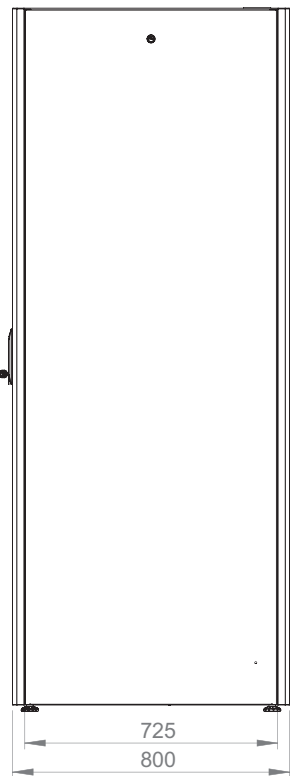

Side view

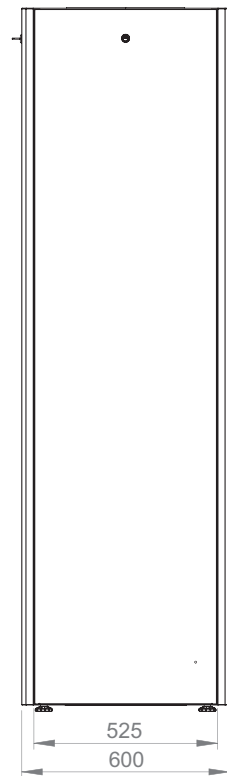

Rear view

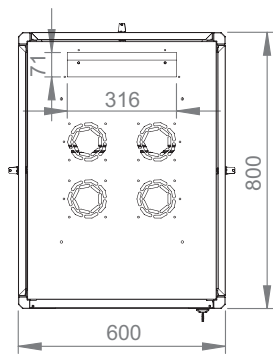

Top view

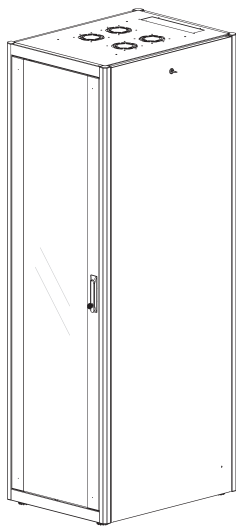

Isometric view

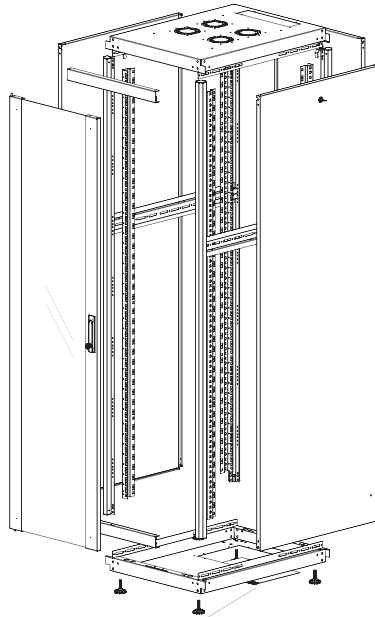

Exploded view

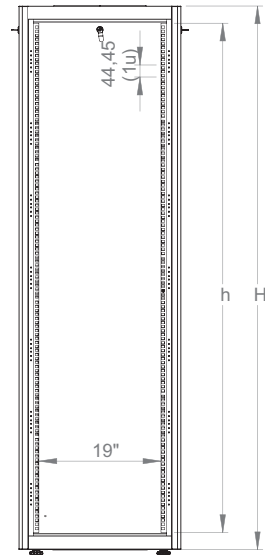

Dimensions in width and height

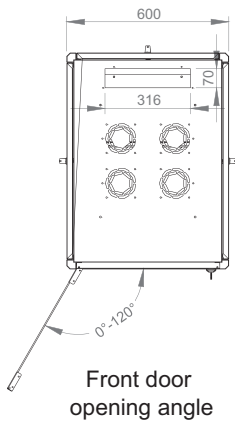
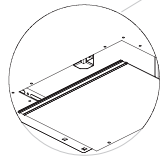

Front door opening angle

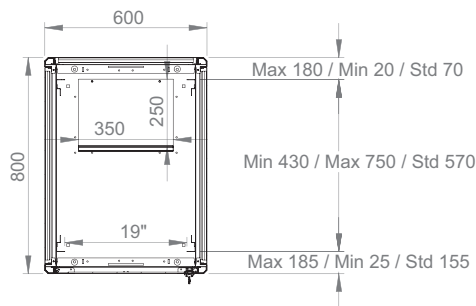

Max/std/min equipment mounting distance

| | h | H |
|------------|---------|---------|
| 22U | 978 mm | 1125 mm |
| 26U | 1155 mm | 1300 mm |
| 32U | 1422 mm | 1560 mm |
| 36U | 1600 mm | 1744 mm |
| 42U | 1867 mm | 2010 mm |
| 47U | 2089 mm | 2236 mm |