

10713-115 19" FAN UNIT, 1 U, WITH FRONT SWITCH, 6 FANS, 24 VDC

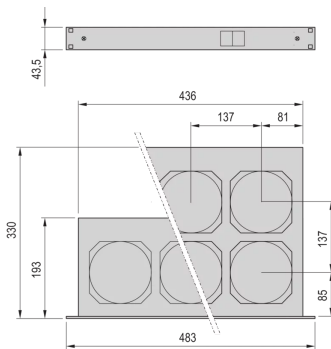
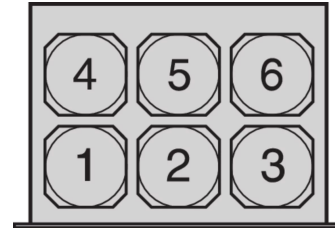

KEY FEATURES

Can be adapted to subracks

Contact protection in accordance with DIN EN ISO 13857

PRODUCT ATTRIBUTES

Product Type: Fan Unit

Input Voltage DC: 24 V min

ADDITIONAL PRODUCT DETAILS

Front-mounted, illuminated mains switch on AC devices, coupled with additional rear mains outlet; mechanical strain relief for mains input and mains output cables.

Please order mains cable separately.

Wide-range input voltage (86-...-264-VAC) available on request.

CERTIFICATIONS

EAC

CE

ROHS
COMPLIANT

North America

All locations

+1.763.422.2661

Chat with us:

schroff.nvent.com

Europe

Straubenhardt, Germany

+49.7082.794.0

Betschdorf, France

+33.3.88.90.64.90

Warsaw, Poland

+48.22.209.98.35

Assago, Italy

+39.02.932.7141

Chat with us:

schroff.nvent.com

Asia

Shanghai, China

+86.21.2412.6943

Qingdao, China

+86.532.8771.6101

Singapore

+65.6768.5800

Shin-Yokohama, Japan

+81.45.476.0271

Chat with us:

schroff.nvent.com

Middle East & India

Dubai, United Arab Emirates

+971.4.378.1700

Bangalore, India

+91.80.6715.2001

Istanbul, Turkey

+90.216.250.7374

Chat with us:

schroff.nvent.com



Our powerful portfolio of brands:
nVent.com **CADDY** **ERICO** **HOFFMAN** **RAYCHEM** **SCHROFF** **TRACER**

© 2023 nVent. All nVent marks and logos are owned or licensed by nVent Services GmbH or its affiliates. All other trademarks are the property of their respective owners.

nVent reserves the right to change specifications without notice.